



# COCONUT RHINOCEROS BEETLE (CRB) - PANEL TRAP

May 2026

## PURPOSE

Panel detection tools (traps) are used as a tool to monitor for CRB presence. It can also be used in areas with high beetle populations to capture some of the beetles in the environment. The trap in this kit utilizes a pheromone lure that attracts both male and female adult beetles.

## EXPECTIONS

These traps are a tool for helping detect and capture CRB. Trapping alone is unlikely to result in adequate control of populations. We recommend pairing trapping with additional control strategies. Additional information can be found at [crbhawaii.org](http://crbhawaii.org)

## SAFETY & WARNINGS

Users are responsible for following this protocol and all relevant laws for the use of these materials. Users are solely responsible for safety and proper use. The user assumes all responsibility for injury, damage, undesirable outcomes, and misuse upon taking possession of these materials.

Do not deploy traps over or near anything that can be damaged if the trap falls or gets blown by wind.

## MAINTENANCE

1. Check trap at least once a month to remove beetles and debris.
2. Freeze all beetles found in the trap for 24 hours to ensure they are dead, then dispose.
3. Lures will need to be replaced every 3 months or until the lure appears dry. For replacement lures, pick up at a local distribution center or contact the CRB Response. Store lures in freezer or a cool area ready to use.

## KIT CONTENTS

- |  |  |
|--|--|
| 1. Trap top (Triangle; small hole)     | 7. Sticker (may come attached)               |
| 2. Trap bottom (Funnel, large hole)    | 8. Lure                                      |
| 3. Hook (specific type may vary)       | 9. Paracord (long with knot in center)       |
| 4. Trap body (long rectangular panels) | 10. Collection cup                           |
| 5. Plastic retainer clip/paracord      | 11. Twist tie (not pictured; to secure lure) |
| 6. Zip ties                            |  |

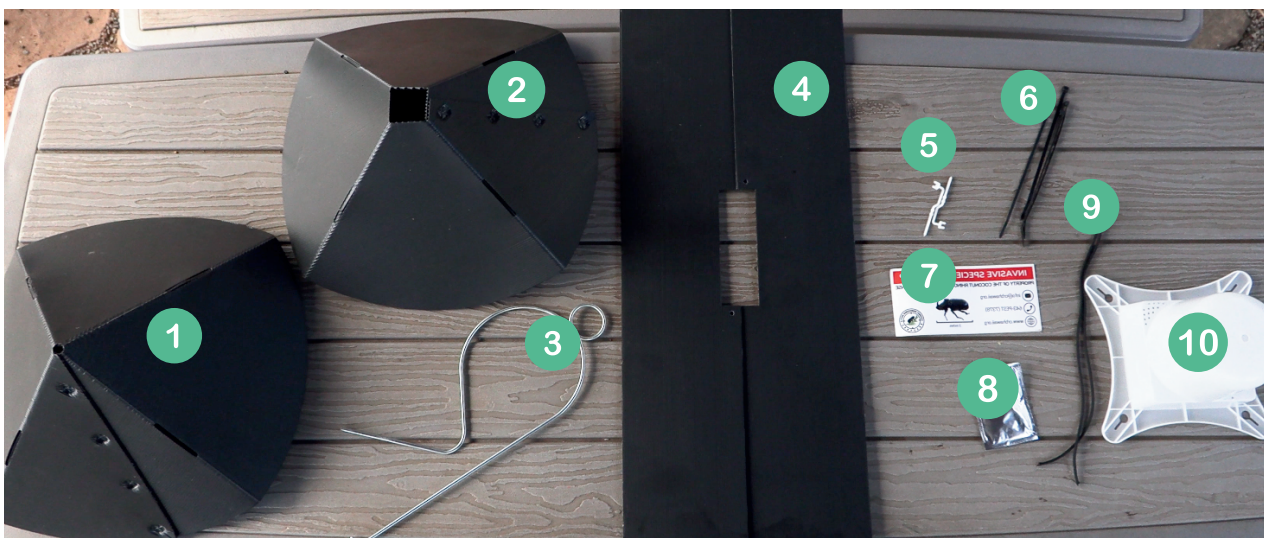

*This kit is intended for those located in Coconut Rhinoceros Beetle affected areas that are not part of an active eradication program. These materials and their distribution is funded by the State of Hawaii through Act 236. This kit is not a retail item and should not be sold.*

**Contact CRB Response: [crbhawaii.org](http://crbhawaii.org) | [info@crbhawaii.org](mailto:info@crbhawaii.org)**



## CONSTRUCTION PROCEDURE

1. Arrange the trap body so that the panels are perpendicular (plus sign when viewed on end) and align the corners with the four pre-cut slots of the funnel section and insert as far as possible. Note: The funnel, when fully open, will have a square-shaped opening at the bottom.
2. Align the collection cup corners with the body panel section corners so that the trap bottom funnel empties inside the cup.
3. Insert a white plastic retainer clip through the remaining panel section holes protruding through the funnel section. The bottom end of the clip connects to the cup to allow easy access during trap checks.
4. Attach one side of the cup to the body panel with zip ties passed through the cup corner holes and the body panel holes. This should sandwich the bottom funnel in place.
5. Align the upper panel section corners with the four pre-cut slots of the trap top (hood section) and insert as far as possible, similar to the attachment of the trap bottom.
6. Insert the two loose ends of the paracord through the two opposite holes of the panel section corners protruding through the hood section. The center loop of the paracord should be centered above the top point of the hood section. Tie knots at the open ends of the paracord to secure
7. (optional) Secure zip ties to the remaining corners
8. Attach the hook to the loop at the top of the paracord.
9. Open the lure by removing the outer bag. Depending on the lure type, it may be a silver foil packet or a clear plastic wrapper. If the lure is a green plastic cup, also remove the seal over the emulsion.
10. Attach the lure to the pre-cut holes directly above the opening in the center of the trap body using a zip tie/coated wire.

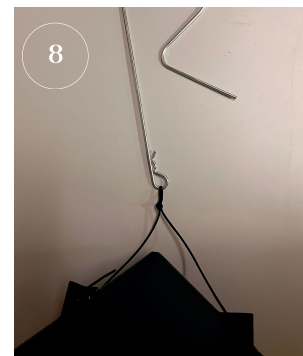
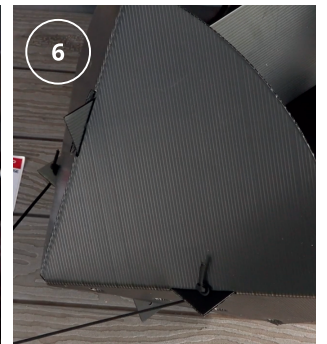
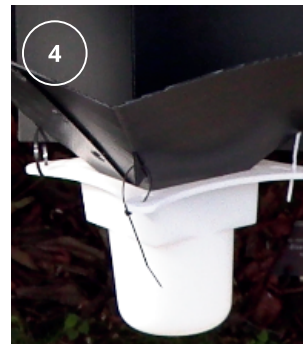

**FOLLOW ALONG  
WITH THIS VIDEO  
[CRBHAWAII.ORG/  
COMMUNITY](https://www.crbhawaii.org/community)**



## DEPLOYMENT RECOMMENDATIONS

1. Trap should be placed in a secure area that will prevent tampering with or pose any hazards to the public.
2. If placed in trees, select those with sturdy limbs that will support the weight of the trap and resist swaying in the wind.
3. Try to deploy in areas without foliage or other barriers blocking the path to the trap.
4. Place >100 feet from host palms or desirable breeding material, ideally on a path between the two. Traps placed immediately next to palms and breeding sites have reduced catch rates.

*For most recent updates to this procedure and for additional relevant Coconut Rhinoceros Beetle information, please contact the CRB Response Program*